

**GLENBROOK HIGH SCHOOLS
District Business Office**

TO: Dr. Mike Riggle

FROM: Kimberly L. Ptak

DATE: JUNE 9, 2014

RE: CAPITAL OUTLAY REQUEST GBN FURNITURE

Recommendation

It is recommended that the Board of Education approve a furniture purchase in an amount not to exceed \$18,000.

Background

At the March 10th board meeting, the Board of Education approved capital outlay requests for GBN and GBS to be funded out of the FY 14/15 building budget. Typically all capital outlay requests are identified by this board meeting, but as building administration completes its budgeting process sometimes additional requests surface. GBN would like to bring forward an additional capital outlay request for furniture at an estimated cost of \$18,000. Since the work is below the required bidding threshold of \$25,000, multiple quotes will be received. Purchase will not exceed \$18,000.

The following summary is provided by John Finan.

Miscellaneous Classroom Furniture

\$18,000

With the conversion of current Social Studies lab A208 into a large classroom and flexible learning space, we want to outfit the room with classroom furniture that provides multiple collaborative workstations along with a large group presentational space, responsive to needs in a one-to-one learning environment. This classroom will be used by multiple academic departments and for some larger cross-curricular combined classes. See sketch of furniture layout attached.



Acute Boomerang Plan



Acute Boomerang Table with Opti

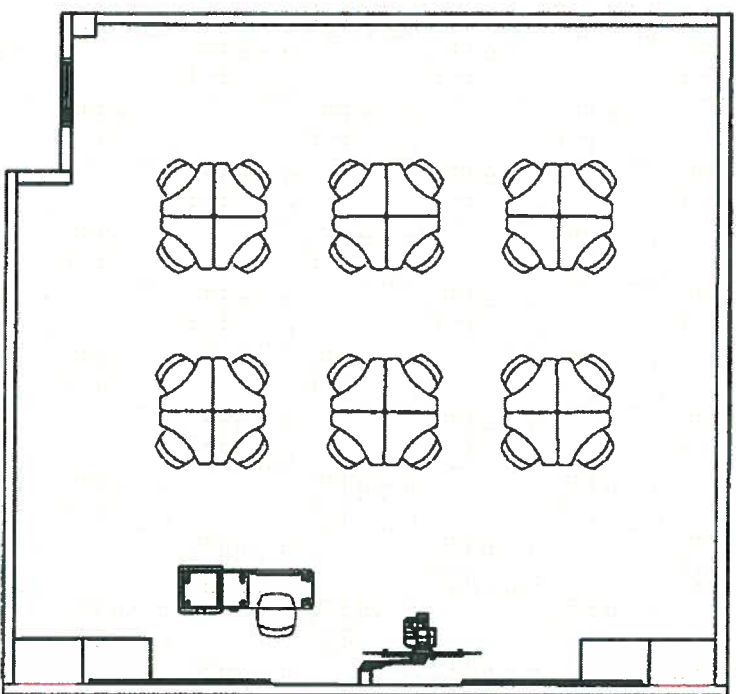
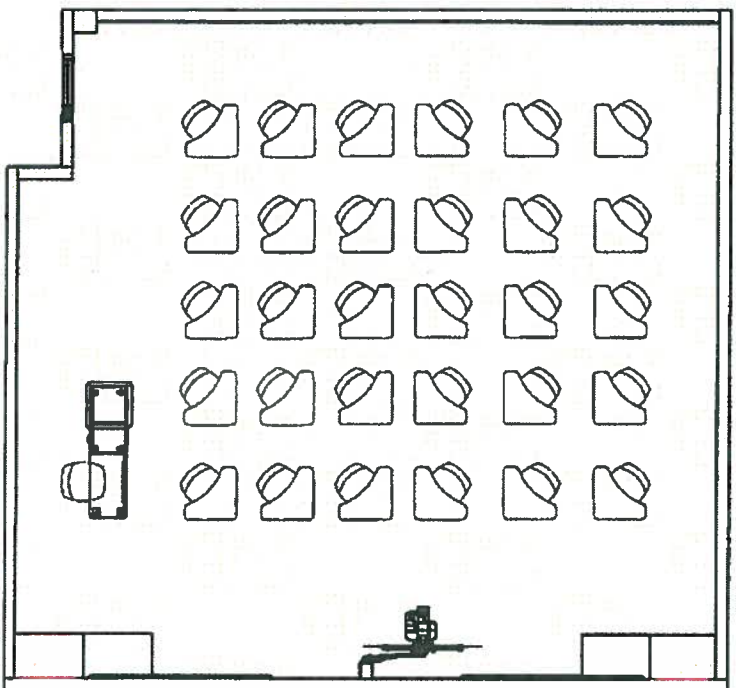

Acute Boomerang Table with Opti

