

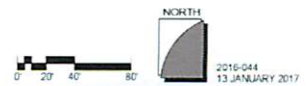

Glenview Park District
Glenview Ice Center Feasibility Study - Site Context



**GLENBROOK HIGH SCHOOLS
Facility Committee Meeting September 29, 2009
District Business Office**

TO: Facility Committee

FROM: Kimberly L. Ptak

DATE: SEPTEMBER 29, 2009

RE: DISCUSSION: Ice Rink Land Swap

Several years ago, discussions between the Village of Glenview and district administration began about a potential "land swap." The ice rink, which is located just north of the district office, will have a future need for a second sheet of ice. The only space possible to lay this second sheet of ice is in the area of the current district office parking lot. In exchange for district land, the ice rink would give us approximately 50 feet of land to the east of their existing parking lot and building. The district would be able to use the 50 feet of land to reconfigure the layout of athletic fields at Glenbrook South and, as a result, gain an additional field.

Attached is a diagram that shows the effect of the land swap.

The estimated cost to the district to fill the existing parking lot, build a new parking lot east of the district office and add detention for both the new parking lot and new field is \$970,000. In addition, there is a cost to prepare the new field with grading, irrigation and drainage of approximately \$495,000.

At this point, we are not recommending that we move forward with this land swap. The cost is very close to that of an artificial turf field which would result in many more hours of use than another natural grass field.

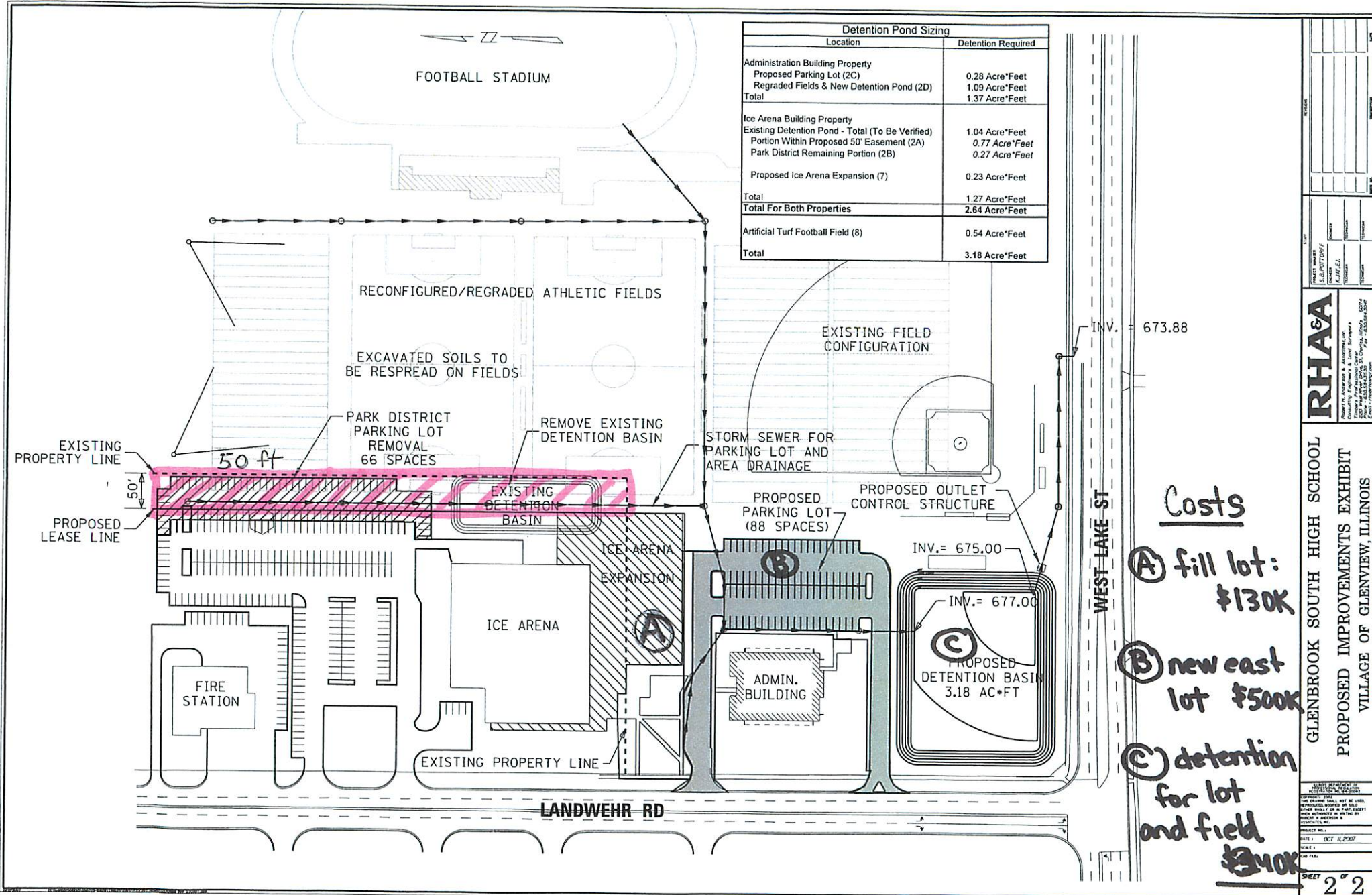

RH&A

GLENBROOK SOUTH HIGH SCHOOL
 PROPOSED IMPROVEMENTS EXHIBIT
 VILLAGE OF GLENVIEW, ILLINOIS

DATE: OCT 11, 2007
 SHEET 2 OF 2